

SGM-180W

Monocrystalline Solar Panel (SGM Series)

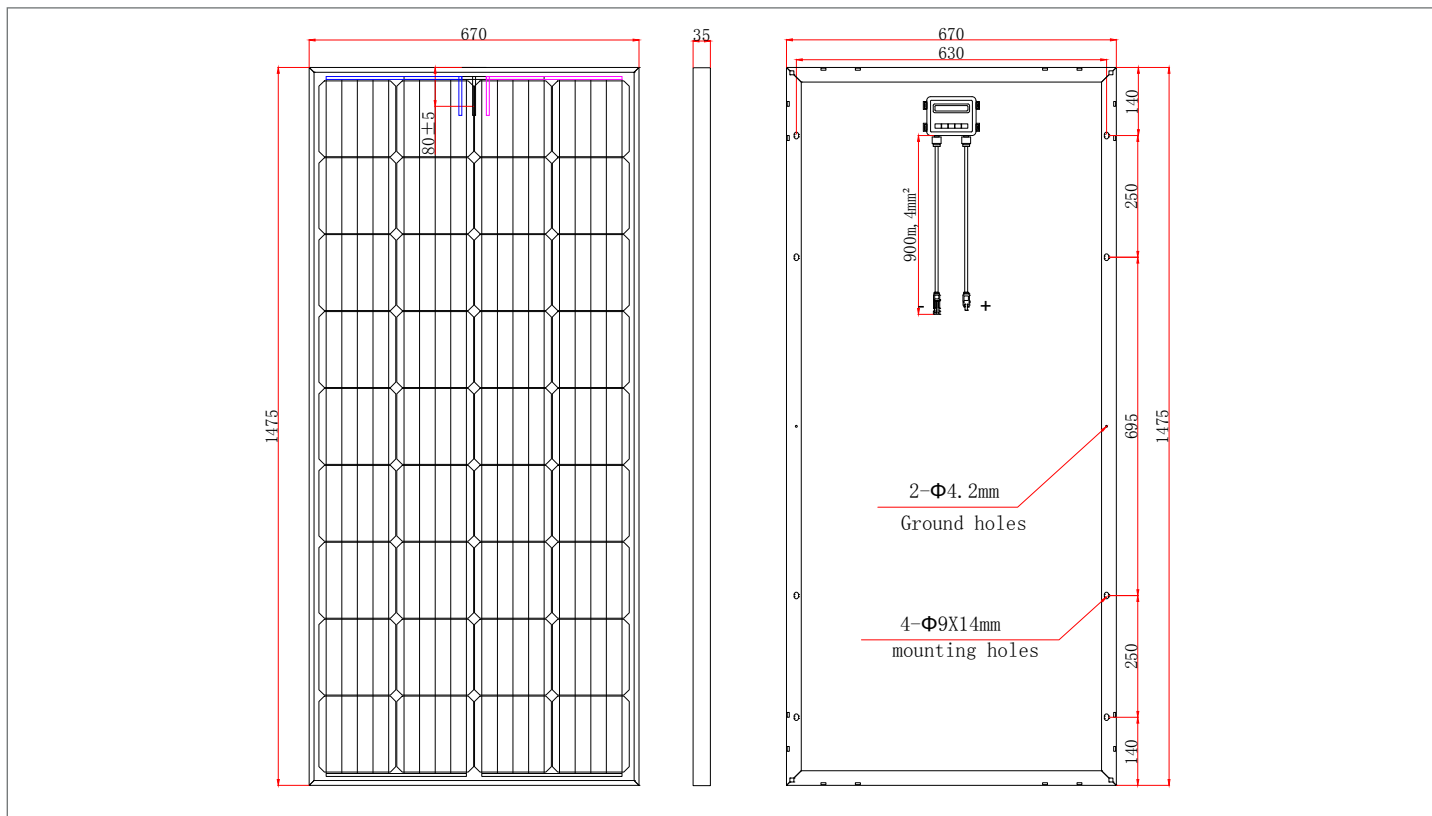

Module Diagram



Electrical Characteristics

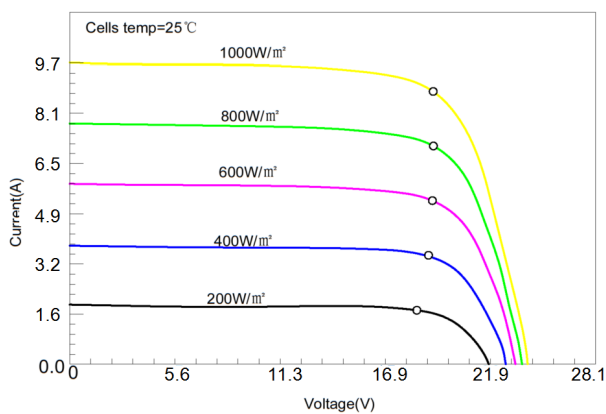

Maximum power(Pmax)	180W
Open-circuit voltage(Voc)	23.4
Voltage at Pmax(Vmp)	19.8
Short-circuit current(Isc)	9.64
Current at Pmax(Imp)	9.09
Cells Efficiency(%)	20.60%
The maximum system voltage	1000VDC(IEC)
Power temperature coefficient	-0.43%/°C
Voltage temperature coefficient	-0.34%/°C
Current temperature coefficient	0.05%/°C
Output power tolerance	±3%
Operating Temperature	-40~85°C

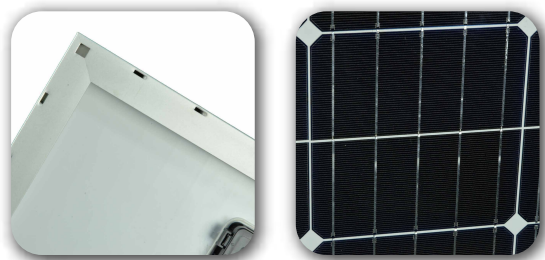

— Product details —

Specifications

Solar cell brand	A grade solar cells
No.of cells and connections	36(4*9)
Module dimension	1475*670*35mm
Weight	10.72KG
Waterproof junction box	IP65/IP67
Warranty	10 year and service life 25 years